



R READING MUSEUM

Gallery Sensory Map and Information Packet

2022

Ground Floor

- 1 Reception
- 2 Shop
- 3 Museum Entrance
- 4 Welcome Gallery
- 5 Story of Reading Gallery
- 6 Earley Charity Room (booked events only)
- 7 Ceremony Room (Reading Register Office)



*Please Note:
During Museum My
Way Days ECR will be
a Break Away Area*

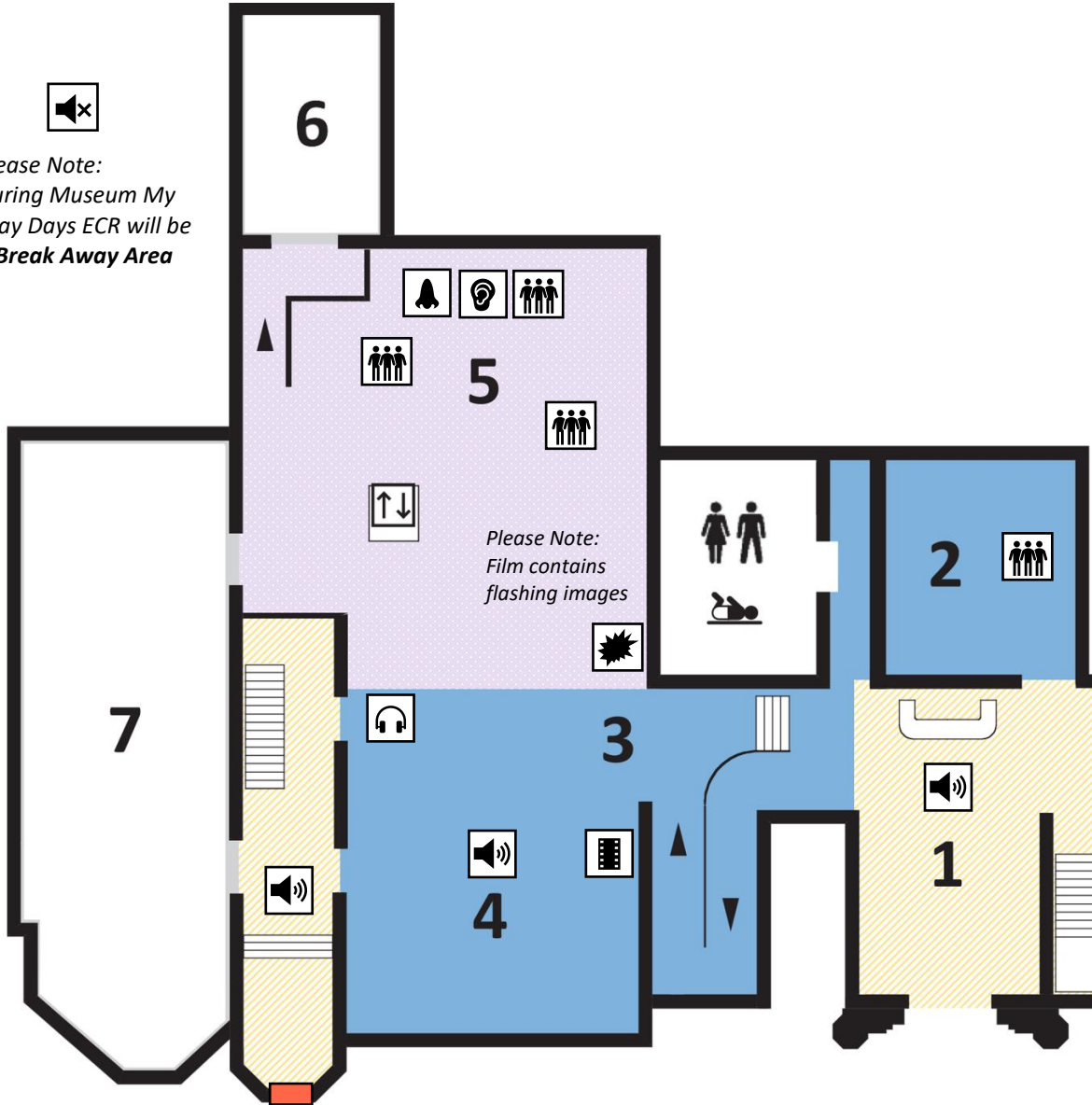

Audio Interactive	Smell Interactive	Small Space	Dimly Lit	Brightly Lit
Audio Interactive With Headsets	Quiet Area		Natural Light	
Film with Audio	Noisy Area			
Lifts	Stairs	Ramp	Toilets & Baby Changing	

Ground Floor

Museum Wide General Sounds

Lift:

The lift has loud vocal audio that can be heard on all three floors when activated

Concert Hall:

The Concert Hall is next to the museum in the Town Hall side of the building. In the event of a concert or organ recital the sounds can be heard on all three floors of the museum.

Stairwell:

Please note that there will be echoes within the stairwell. If there is a ceremony occurring in the Ceremony Room loud music may be heard.

Ground Floor

Entrance

The entrance to the museum is very well lit and carpeted. There are 3 non-digital interactives: trail bags, trail sheets and trail bingo sheets.

Story of Reading

The gallery is dimly lit but the display cases are well lit. Please note bright spotlights in areas. It is a small space that loops around itself and is carpeted. There are 4 non-digital interactives – pull up information signs, dress up, Abbey stone replica and 3 buttons which play music. All 3 tracks are on a high volume and can be heard on the rest of the ground floor and the first floor. The Abbey Aromas interactive contains smells. There are some human remains (arm bone) in the Abbey Case.

In the final case, the Station Time-lapse Video contains flashing imagery.

Welcome Gallery

The gallery is brightly lit with bright spotlights lit. It is a large space. The floor is laminated. There are 2 two digital interactives and a video projector which will be turned off during Museums My Way hours. The macroscope interactive makes a loud humming noise.

First Floor

The Bayeux Tapestry Gallery



*Please Note:
Do not open doors. Loud Alarm activated when open*

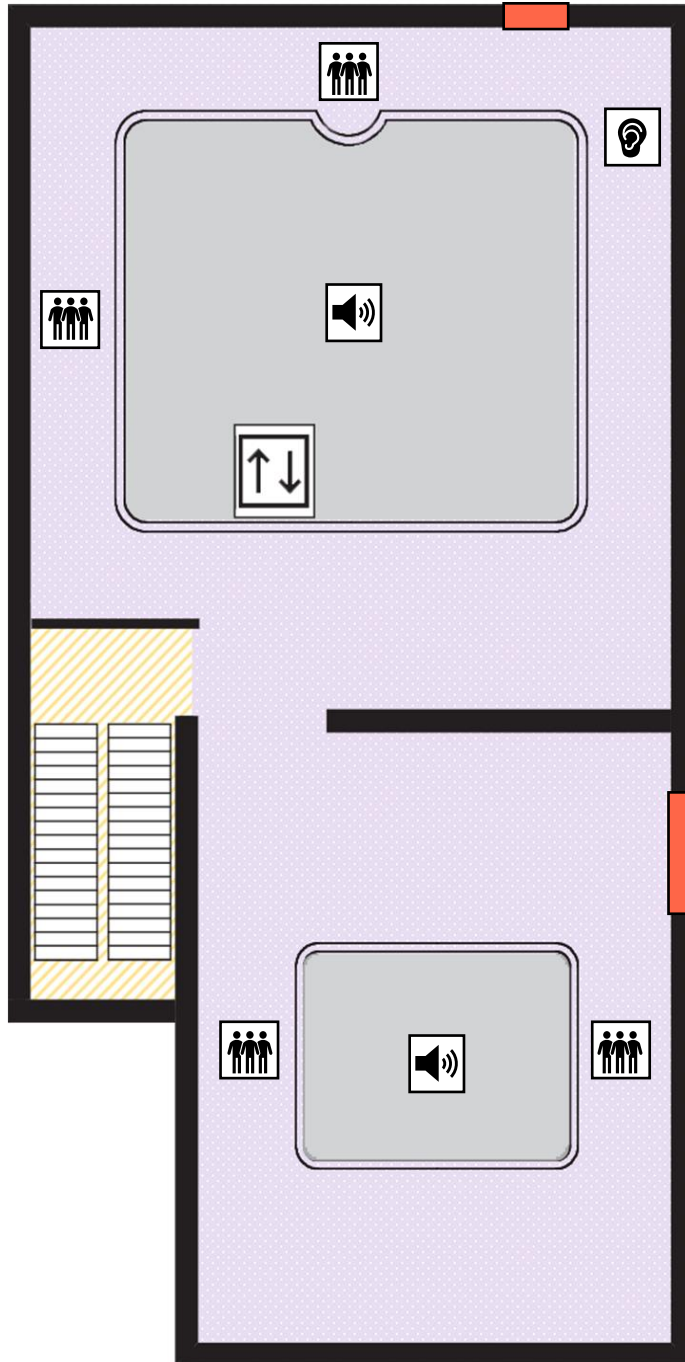

*Please Note:
Do not open doors.
Loud Alarm activated when open*

- | | | | | |
|---------------------------------|-------------------|-------------|-------------------------|--------------|
| Audio Interactive | Smell Interactive | Small Space | Dimly Lit | Brightly Lit |
| Audio Interactive With Headsets | Quiet Area | | Natural Light | |
| Film with Audio | Noisy Area | | | |
| Lifts | Stairs | Ramp | Toilets & Baby Changing | |

First Floor

The Bayeux Tapestry Gallery

The gallery and the display cases are dimly lit to preserve the Bayeux Tapestry. The floor is carpeted and the walkways around the cases are narrow with a balcony view over the ground floor. There are two non-digital interactives – robe and crown dress up and the trail sheet. Sound effects (weapon clashes, men screaming, horses etc) depicting the battle do play on an occasional basis. These sound effects will be turned off for Museums My Way hours.

Second Floor

- 1 Sir John Madejski Art Gallery
- 2 Window Gallery
- 3 Huntley & Palmers Gallery
- 4 Green Space
- 5 Atrium
- 6 Silchester Gallery
- 7 Silchester Annexe

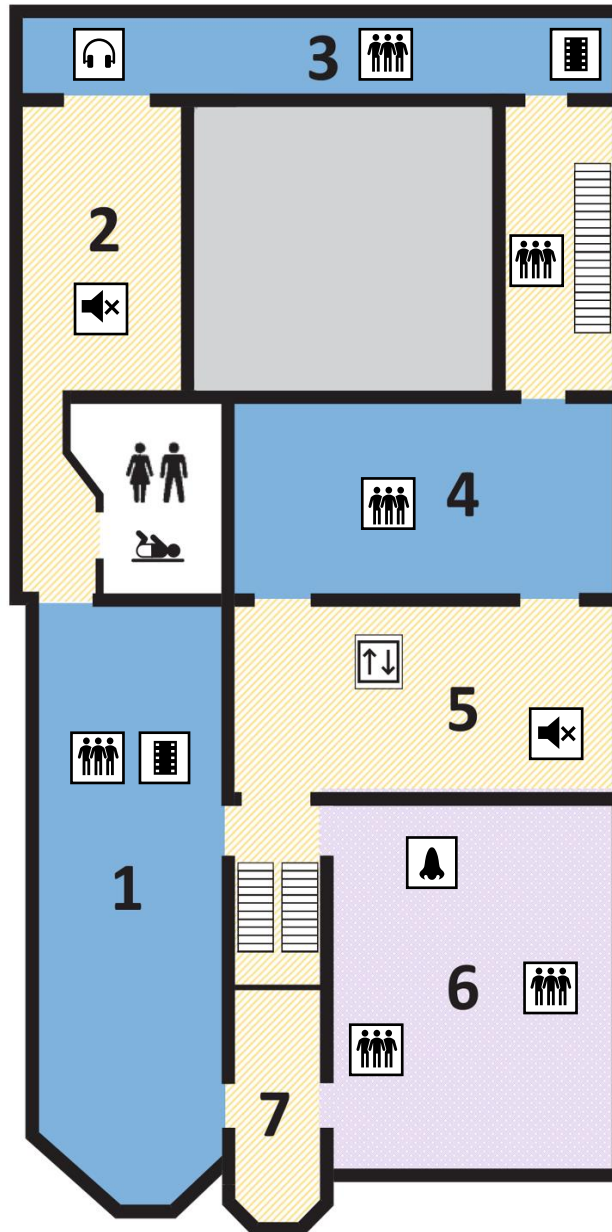

Audio Interactive	Smell Interactive	Small Space	Dimly Lit	Brightly Lit
Audio Interactive With Headsets	Quiet Area			
Film with Audio	Noisy Area		Natural Light	
Lifts	Stairs	Ramp	Toilets & Baby Changing	

Second Floor

Atrium

The gallery is naturally lit and spacious with tiled flooring. It is prone to echoes from the lift and the nearby office door. Soft seating is available

Green Space

The Green Space features a collection of taxidermy and some animal remains, which visitors may find distressing. The gallery is small and brightly lit, with bright spotlights. The floor is laminated. There are 7 non-digital interactives: rocks, urchin pictures, colouring in/trail sheets, trail bags and colours. There is one digital interactive: an online collections screen (emits no sound).

Huntley & Palmers

The gallery is well lit and carpeted, with brighter lighting in the display cases. There are display drawers which visitors can pull out and 3 non-digital interactives: a biscuit sorter, a senza piano (emits loud sound) and reminiscence stories told on headphones. There is also a television with seating which shows 3 different videos every 12 minutes, which can be muted or placed on low volume. The video can be heard from Green Space and Windows. Video will be turned off for Museums My Way hours.

Windows Gallery

The gallery is naturally lit and spacious with wooden flooring and a minimal look. It is prone to echoes from the nearby office door, toilets and Art Gallery doors, as well as floor creaks. There is one 1 digital interactive: the silent online collections screen. Valpy Street traffic can be heard from the windows at the side. The Gallery's temperature is typically warm over the entire year

Art Gallery

The gallery is well lit and spacious with wooden flooring. During the exhibition period, it typically contains video interactives with audio. Video can be muted or placed on low volume and will be turned off for Museums My Way hours.

Silchester Annexe

The gallery is very small and well lit. The walls are lined with pottery display cases and colour coded laminated sheets at the bottom. There is a bookcase featuring categories relevant to the museum's objects as well as children's books. As it is an open space close to the staircase, it is prone to echoes from the Atrium and movements inside the Silchester and Art galleries.

Silchester

The gallery is big and dimly lit with some natural light. Some display cases are well lit whilst others are dimly lit to preserve objects. It is mostly carpeted with some wooden flooring at the gallery's main entrance. floor creaks occur through most of the gallery. There are 5 non-digital interactives: Roman dress up, mosaic making, Roman game, recipe book (contains smells) and diary book. There are also display drawers visitors can pull out to view and maps at the side of the Silchester scale model.

